



**Ahead Diagnostics, Ltd.**  
 7800 N. Mopac, Suite 115  
 Austin, Texas 78759  
 (512) 795-9950 Fax (512) 795-9951  
 www.aheaddiagnostics.com

Patient's Name \_\_\_\_\_ DOB \_\_\_\_\_

**Exam ordered:**

- Periapical (s), tooth # \_\_\_\_\_
- Bitewings  2 views  4 views
- Full Mouth Survey
- Panoramic  Standard  Orthogonal
- Cephalometric  Lateral  Posterior Anterior
- Cephalometric tracing (specify) \_\_\_\_\_
- Diagnostic photographs, 3 extraoral and 5 intraoral
- Radiologist interpretation and report
- Duplicate records to \_\_\_\_\_

**Volumetric Scanner (CT)**

- Radiologist interpretation and report
- TMJ Study
- Implant Study, Maxilla and Mandible
- Implant Study, Maxilla, tooth # \_\_\_\_\_
- Implant Study Mandible, Tooth # \_\_\_\_\_
- Isolate Tooth # \_\_\_\_\_
- Genial Tubercle Study
- Other Specific Study \_\_\_\_\_
- SimPlant Conversion and Reconstruction
- SimPlant One Shot
- Duplicate records to \_\_\_\_\_

Comments or Special Instructions: \_\_\_\_\_  
 \_\_\_\_\_  
 \_\_\_\_\_  
 \_\_\_\_\_

**Media:**

- Paper  Film
- CD →  DICOM  .Jpeg/Other  Dolphin

Radiographs due in office by \_\_\_\_\_

Referring doctor \_\_\_\_\_ Date \_\_\_\_\_  
(Please Print)

Dr's Phone number \_\_\_\_\_

**Dr.'s Signature** \_\_\_\_\_  
(Required)

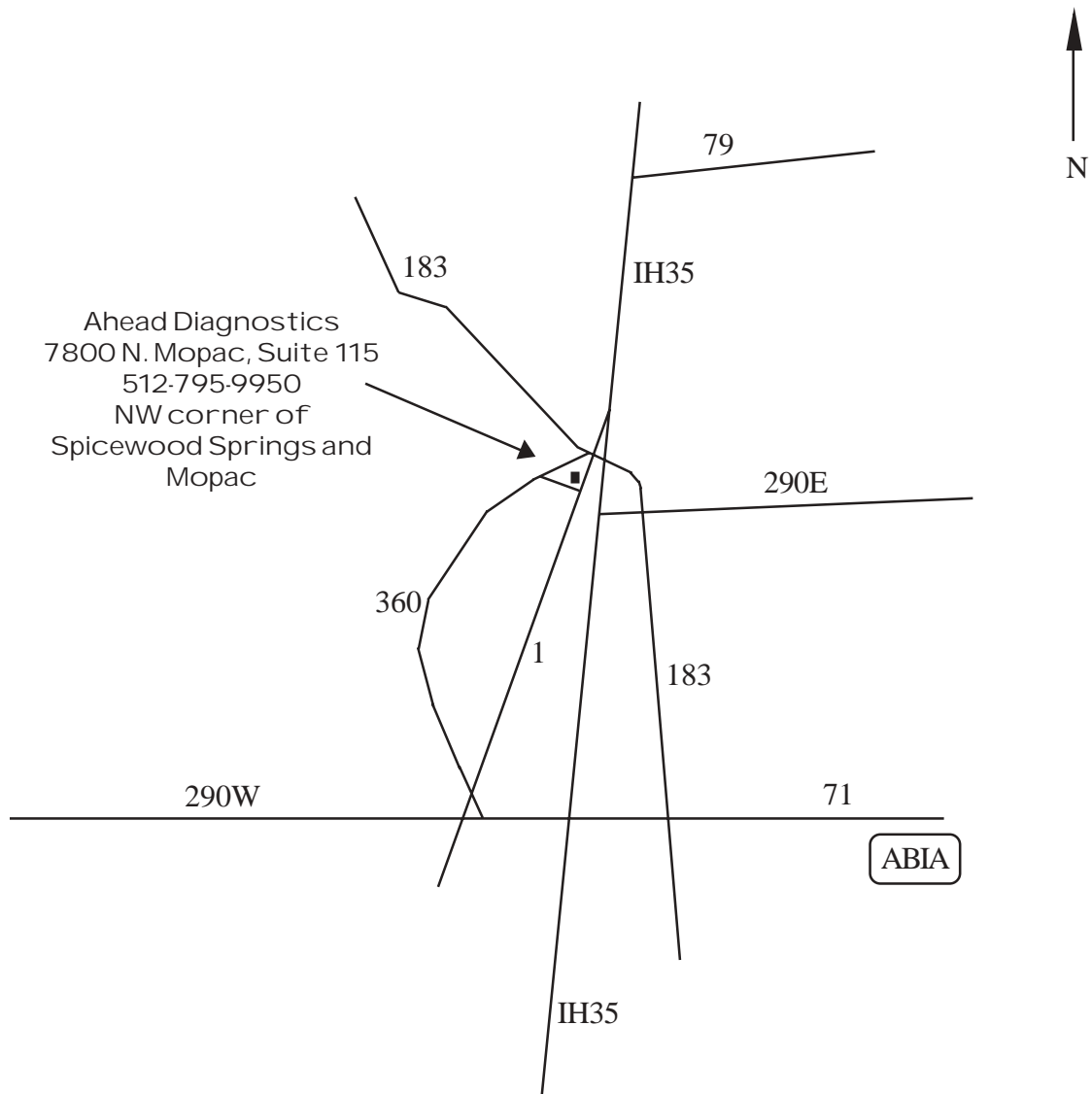

### Driving directions:

From north Austin & other points north

1. Take Mopac (Loop 1) south
2. Take Steck Ave./Anderson Ln./Spicewood Springs Rd. exit
3. Stay on southbound access road proceeding through traffic light at Steck/Mopac intersection
4. Turn right on Spicewood Springs Rd.
5. Turn right into Heritage Plaza (7800 Mopac Blvd.)

From south Austin and other points south

1. Take Mopac (Loop 1) north
2. Take Anderson Ln./Spicewood Springs Rd. exit
3. Turn left on Spicewood Springs Road, crossing over Mopac
4. Turn right into Heritage Plaza (7800 Mopac Blvd.)
5. You will see First American Bank in large letters atop building.